

Kit 1552

RENAULT Megane III, 5-dr Hatchback, 09–

480R
754

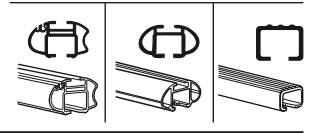
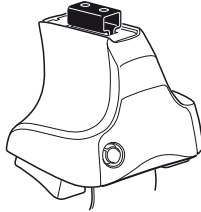

480

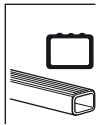
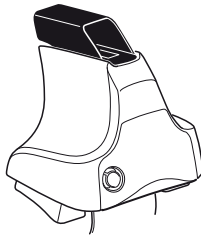

750

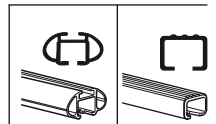
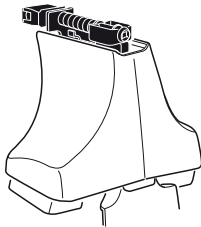

xx kg
 xx lbs + 7 kg
 15,4 lbs = **Max. 65kg**
Max. 143 lbs

80 km/h 50 Mph
 130 km/h 80 Mph
 40 km/h 25 Mph
km/h Mph

THULE
 + **Kit XXXX**

x1 x4 x4
480R/754

x1 x4 x4 x4
480

x1 x4 x4
750

x2	x2	x2	x2	x2
x2	x2	x2	x2	x2
x2	x2	x4	x2	x2
x4	x2	x4	x2	x2

926 x 4

196 x 2
251 x 1
252 x 1

x 1

Kit



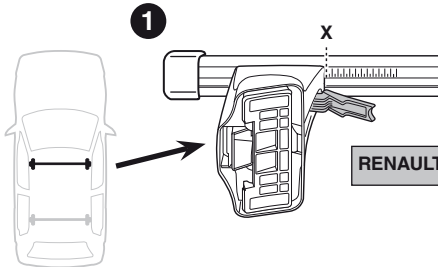

RENAULT Megane III, 5-dr Hatchback, 09-	X
	36

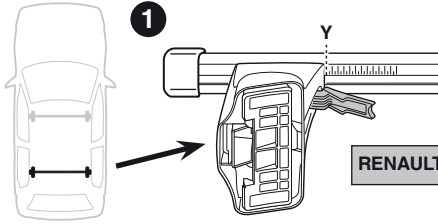

RENAULT Megane III, 5-dr Hatchback, 09-	Y
	32,5

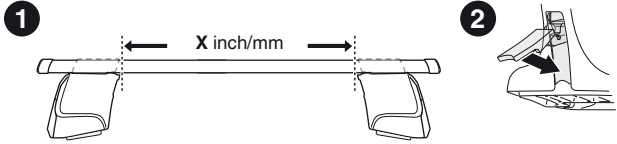
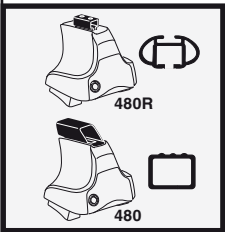

RENAULT Megane III, 5-dr Hatchback, 09-	X inch	X mm
	39 3/4"	1011 mm

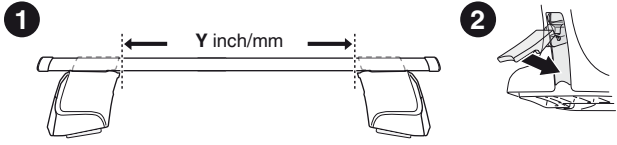

RENAULT Megane III, 5-dr Hatchback, 09-	Y inch	Y mm
	38 3/8"	976 mm

4

RENAULT Megane III, 5-dr Hatchback, 09-

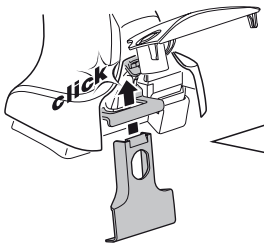
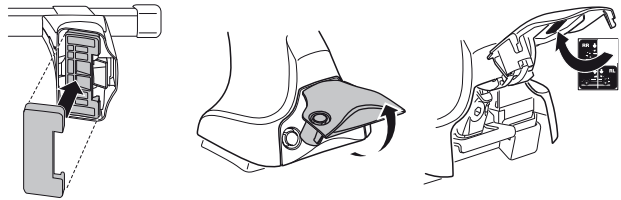
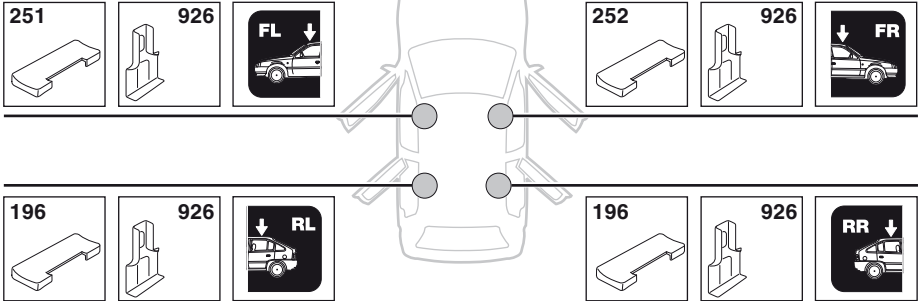

5



	X mm	Y mm	X inch	Y inch
RENAULT Megane III, 5-dr Hatchback, 09-	120 mm	760 mm	4 3/4"	29 7/8"

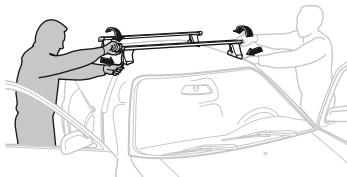
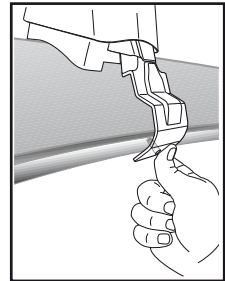
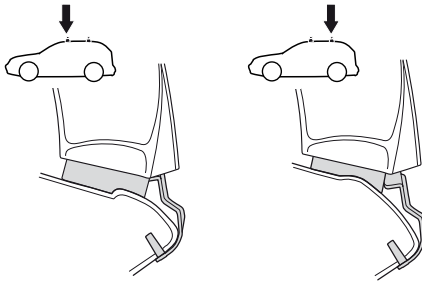
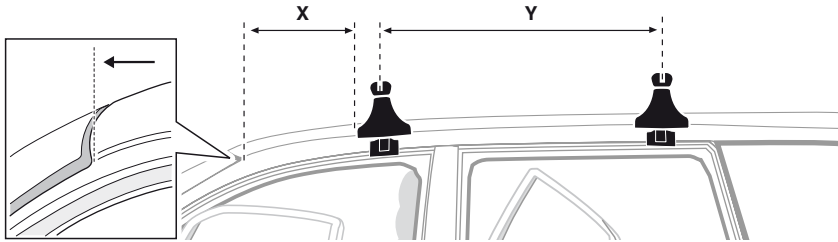

GB/US Tighten alternately

D Die Schrauben abwechselnd anziehen

F Serrer alternativement chaque côté

NL Afwisselend aan de linker- en de rechterkant aandraaien

I Alternare il serraggio delle viti

E Apretar alternativamente

PT Aperte alternadamente

S Dra åt växelvis

FIN Kierrä vuorotellen

EST Pinguldage vaheldumisi

LAT Pievelciet pamišus

LIT Užsukinėkite pakaitomis

PL Śruby dokręcaj naprzemiennie

RU Затягивайте попеременно

CZ Pokręťta багаžníka dokręcaj dokręcaj naprzemiennie.

SK Doťahujte striedavo

SLO Privijajte izmenično.

HR Naizmjenično zategnite

HU Egymástól függetlenül szorítandó

GR Σφιγγετε εναλλάξ

TR Dönüşümlü sıkın

中文 交替拧紧

한국어 번갈아 가며 조이십시오.

日本語 交互に締め付けてください。

ไทย ชันโนแบบสลับ

6



480R/754



480

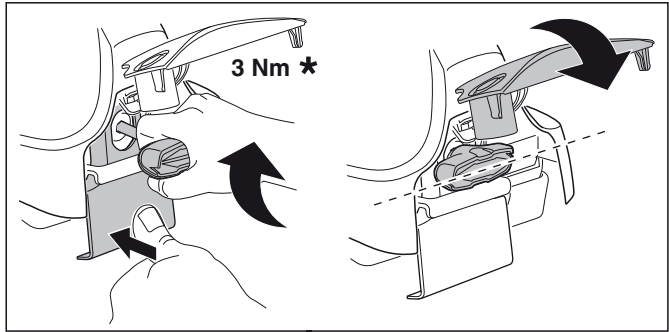
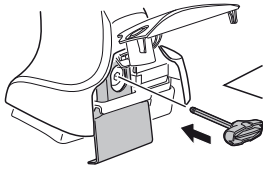

3 Nm *

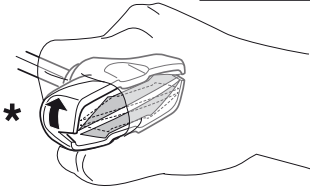

*

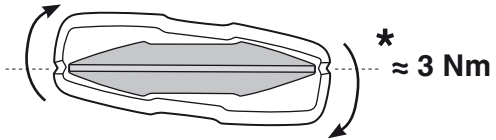

* ≈ 3 Nm



750

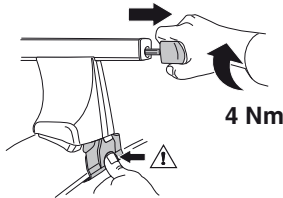

4 Nm

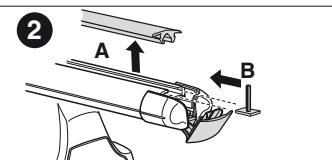
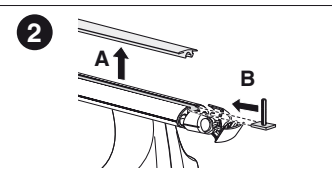
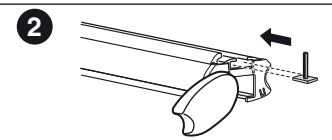
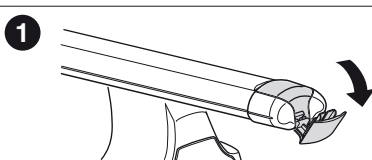
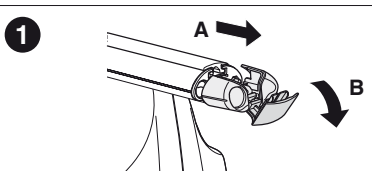
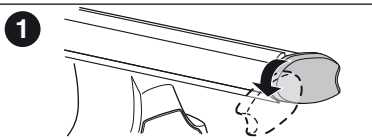
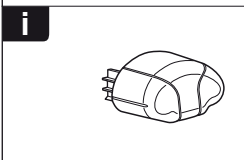
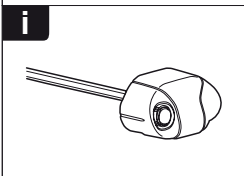
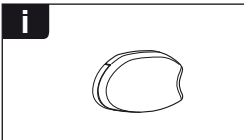
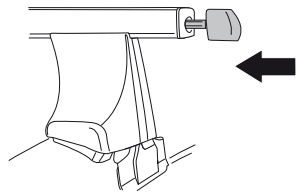



THULE
SWEDEN
**ONE
KEY
SYSTEM**



- 544 (x4)
- 596 (x6)
- 588 (x8)
- NA 510 (x10)
- EUR 452 (x12)
- ASIA



WW ▶ Thule Sweden AB, Box 69, 330 33 Hillerstorp, SWEDEN
NA ▶ Thule Inc., 42 Silvermine Road, Seymour, Connecticut 06483, USA

info@thule.com
customer.service@thule.com

www.thule.com